

Where is the lamp?



The lamp is _____ the table.



The lamp is _____ the table.



The _____.



The _____ the tables.



The _____ the shelf.



The _____.



The _____.

lamp table shelf in on behind under next to
between (zwischen)

Back to school

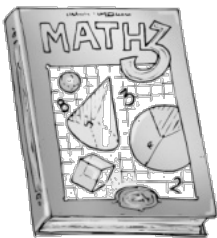
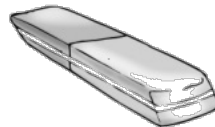
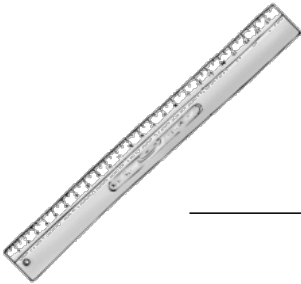
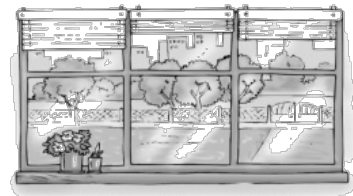
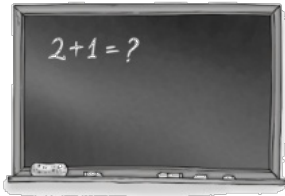

window, pencil, pen, blackboard, schoolbag, book, desk and chair, pencil case, scissors, ruler, rubber

Name:



Winter clothes

A large empty rectangular box with a black border, intended for drawing a yellow pullover.

Draw a yellow pullover!

A large empty rectangular box with a black border, intended for drawing a green scarf.

Draw a green scarf!

A large empty rectangular box with a black border, intended for drawing a pair of black socks.

Draw a pair of black socks!

draw = zeichnen

A large empty rectangular box with a black border, intended for drawing blue trousers.

Draw blue trousers!

A large empty rectangular box with a black border, intended for drawing a pink woolly hat.

Draw a pink woolly hat!

A large empty rectangular box with a black border, intended for drawing a pair of brown boots.

Draw a pair of brown boots!